

5000mA (2500mA+2500mA)

CARD POWER

LA R 7
Compact And Revolutionary Designs

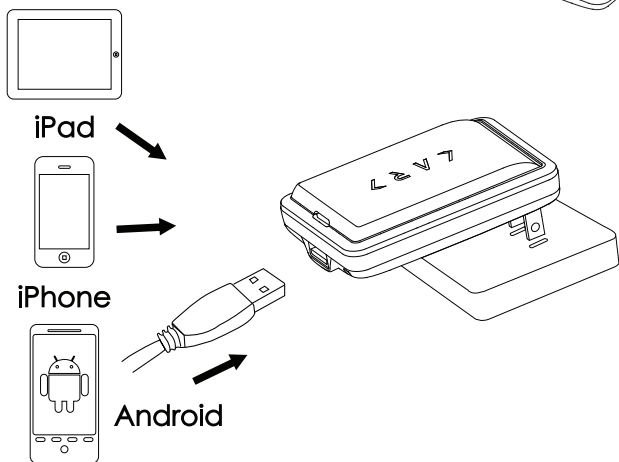
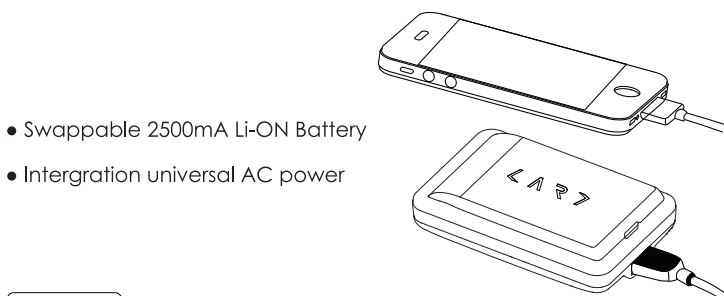
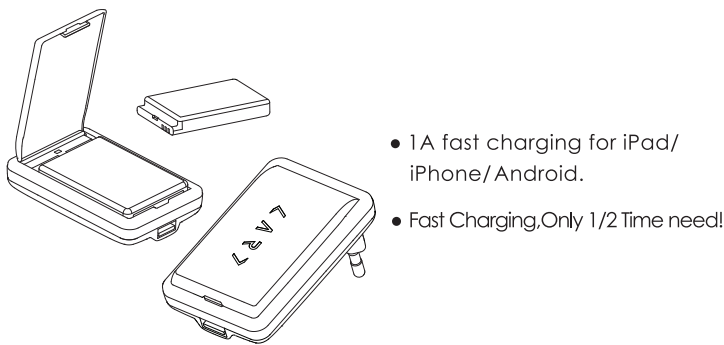
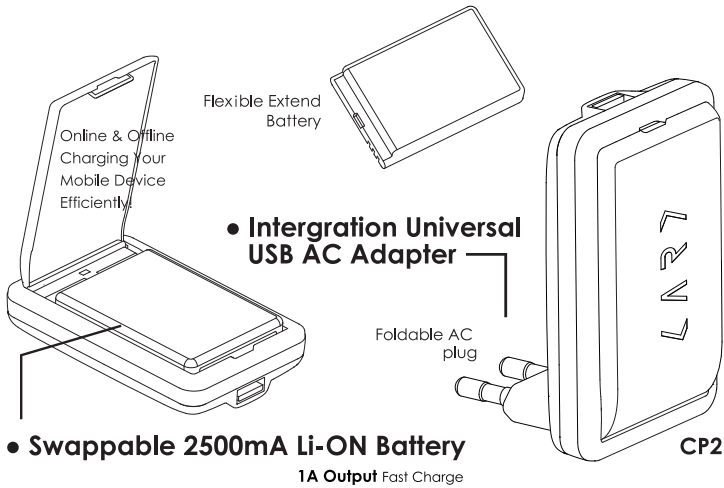

- Can charge your mobile and power bank battery same time.
- CP2 Will charging your phone first and Auto switch to charging battery when phone is fully charged

Specifications:

- Input AC 100~240V
- Output DC: 5V Maxima:1A
- Battery Cap. 2500mA (3.7V)
- Dimensions:86(L)x55(W)x21.6(H)mm
- Weight: 108g

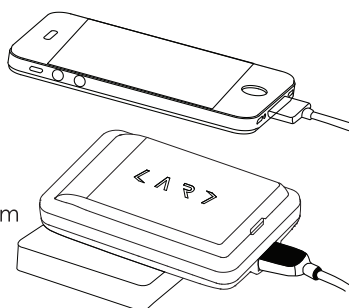

please charge 6 hour above for the first charging

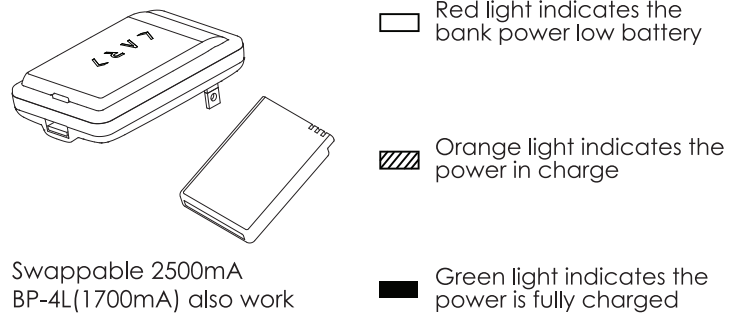
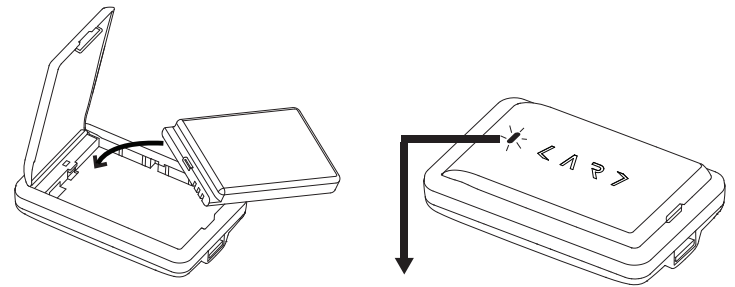

The most efficient Power Bank

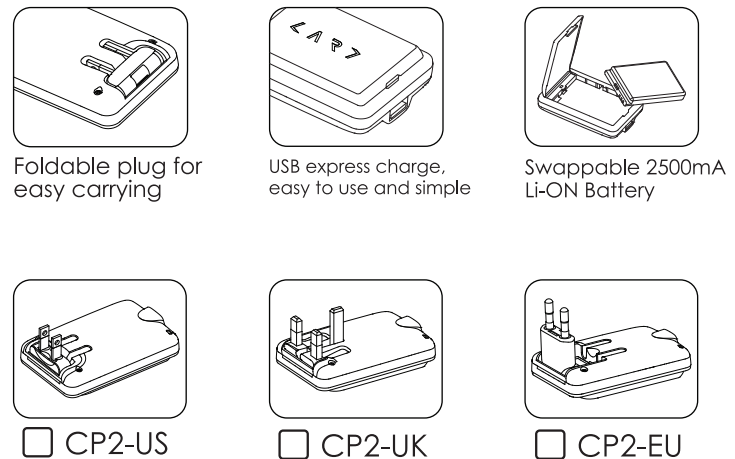

Cautions:

- Keep device use in door and away from Humidity
- Fully Charger battery when purchased
- Do not drop the battery in fire
- Dvice will charging your mobile first and next to battery when plug AC
- USB output 1A only for few defind device others not support but only 500mA



For better environmental protection,waste batteries should be collected separately for recycling or special disposal.

Designed in Singapore,
Assembled in China
www.card-tec.com

